

# UNITY LEVER HANDLE



# UNITY LEVER HANDLE

## Stainless Steel Levers and Knobs

<p>SL101</p>	<p>SL102</p>	<p>SL103</p>	<p>SL104</p>
<p>SL105</p>	<p>SL106</p>	<p>SL107</p>	<p>SL109</p>
<p>SL110</p>	<p>SL111</p>	<p>SL112</p>	<p>SL113</p>
<p>SL114</p>	<p>SL115</p>	<p>SL116</p>	<p>SL117</p>

# UNITY LEVER HANDLE

## Stainless Steel Levers and Knobs

<p>SL210</p>	<p>SL211 / SL211H</p>	<p>SL214</p>	<p>SL217</p>
<p>SL221</p>	<p>SL223</p>	<p>SL225</p>	<p>SL226</p>
<p>SL227</p>	<p>SL228</p>	<p>SL243 / SL243H</p>	<p>SL244</p>
<p>SL251</p>	<p>SL255</p>	<p>SL311</p>	<p>SL344</p>

# UNITY LEVER HANDLE

## Stainless Steel Levers and Knobs

<p>SL345</p>	<p>SL346</p>	<p>SL351</p>	<p>SL410</p>	
<p>SL411</p>	<p>SL412</p>			
<p>SK-01</p>	<p>SK-02</p>	<p>SK-03</p>	<p>SK-04</p>	<p>SK-05</p>

# UNITY LEVER HANDLE

## Stainless Steel Escutcheons and Thumb Turns

SE01

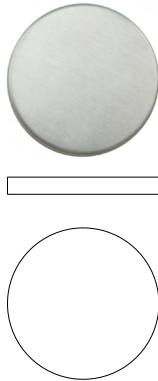

SE02

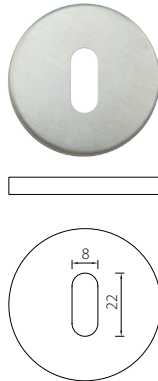

SE03

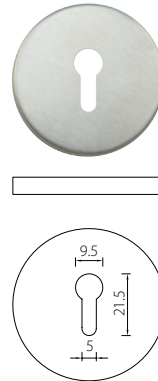

SE04

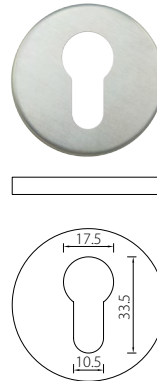

SE05

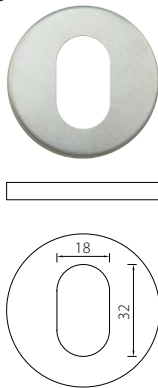

ST01

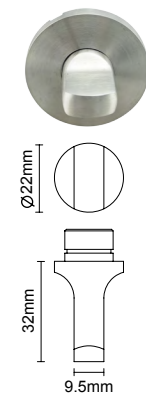

ST02

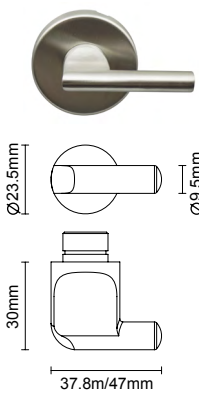

ST03

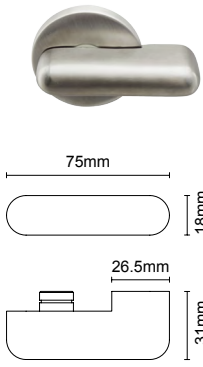

ST04

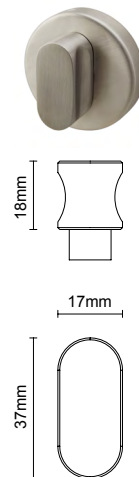

ST05

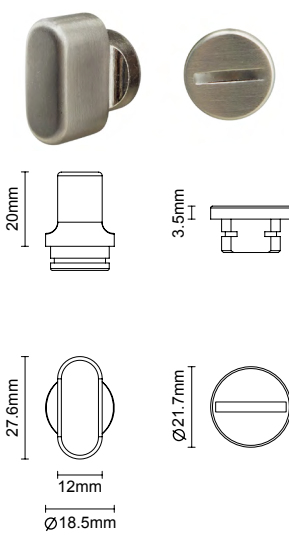

SSSE-1

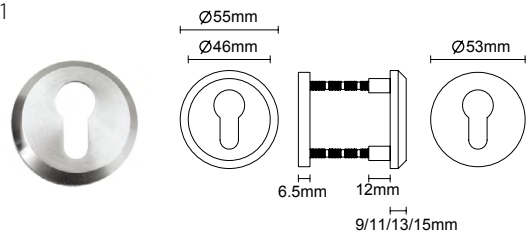

SSSE-2

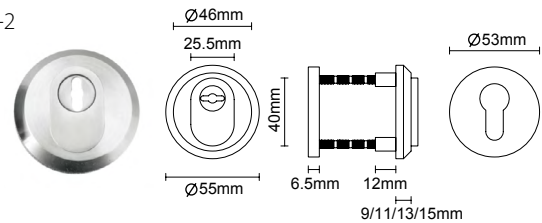



# UNITY LEVER HANDLE

## SR01 Door Handle Series - EN1906 Grade 4

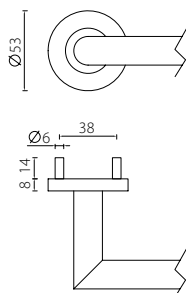

### Application

UNITY SR01 Series handle is built for high frequency usage such as public buildings and commercial offices where potential misuse or deliberate abuse likely takes place

### Specifications and Features

- EN1906 Grade 4 tested and EN1634-1 fire rated
- Made of stainless steel AISI304 (AISI316 is available on request)
- Built with robust spring mechanism
- Concealed screw fixing
- Inner rose indentation to secure the rose cover with a "clean" look on handle
- Hexagonal countersunk and fixing lugs to assist thru-bolt fixing
- Architectural look achieved by minimum edge radius on rose cover



### Tests and Standards



Successfully type-tested for conformity to all of the requirements of EN1906: 2010 (including 240-hours of corrosion resistance requirement of EN1670:2007)



Successfully passed 240-minutes fire test of metal door assemblies to EN1634-1:2014



All tests performed independently and certified by Exova/Warringtonfire/Warrington APT. Test reports and/or certificates are available on request

### Finishes

- Satin Stainless Steel (US32D/630)
- Polished Stainless Steel (US32/629)
- Satin PVD Titanium
- Bright PVD Titanium

\*Other finishes available on request

### Escutcheon Options



Blind



Euro Cylinder



Privacy Thumb Turn and Release Set



### EN1906: 2010 Classifications

4	7	-	1	1	4	0	B
---	---	---	---	---	---	---	---

# UNITY LEVER HANDLE

## SR02 Door Handle Series - EN1906 Grade 3

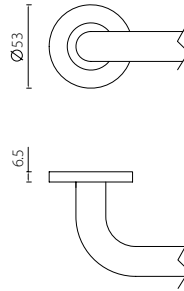
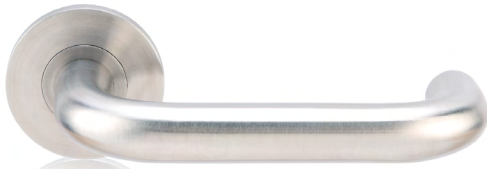

### Application

UNITY SR02 Series handle is built with optimized design for interior and exterior doors suitable for most commercial applications where frequent usage presents

### Specifications and Features

- EN1906 Grade 3 tested and EN1634-1 fire rated
- Made of stainless steel AISI304 (AISI316 available on request)
- 6.5mm rose design to preserve the minimum height with spring mechanism
- Concealed screw fixing
- Inner rose indentation to secure the rose cover with a "clean" look on handle
- Hexagonal countersunk to assist thru-bolt fixing
- Architectural look achieved by minimum edge radius on rose cover



### Tests and Standards



Successfully type-tested for conformity to all of the requirements of EN1906: 2010 (including 240-hours of corrosion resistance requirement of EN1670:2007)



Successfully passed 240-minutes fire test of metal door assemblies to EN1634-1:2014



All tests performed independently and certified by Exova/Warringtonfire/Warrington APT. Test reports and/or certificates are available on request

### Finishes

- Satin Stainless Steel (US32D/630)
- Polished Stainless Steel (US32/629)
- Satin PVD Titanium
- Bright PVD Titanium

\*Other finishes available on request

### Escutcheon Options



Blind



Euro Cylinder



Privacy Thumb Turn and Release Set



### EN1906: 2010 Classifications

3	7	-	1	1	4	0	B
---	---	---	---	---	---	---	---

# UNITY LEVER HANDLE

## SR10 Door Handle Series

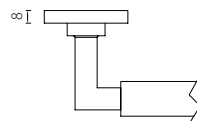
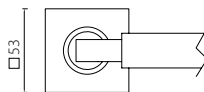
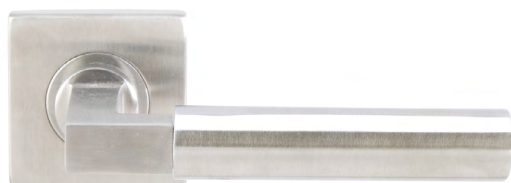

### Application

UNITY SR10 Series handle is built with contemporary square rose design for interior doors suitable for commercial and residential applications

### Specifications and Features

- EN1906 Grade 3 tested and EN1634-1 fire rated
- Made of stainless steel AISI304
- Concealed fixing on both sides of handle preserving a consistent and elegant appearance
- Square inner rose design giving better assistance of rose installation alignment
- Inner rose indentation to secure rose cover with a "clean" and architectural look
- Suitable for retrofitting with existing door prep



### Tests and Standards



Successfully type-tested for conformity to all of the requirements of EN1906: 2010 (including 240-hours of corrosion resistance requirement of EN1670:2007)



Successfully passed 240-minutes fire test of metal door assemblies to EN1634-1:2014



All tests performed independently and certified by Exova/Warringtonfire/Warrington APT. Test reports and/or certificates are available on request

### EN1906: 2010 Classifications

3	7	-	1	1	4	0	B
---	---	---	---	---	---	---	---

### Finishes

- Satin Stainless Steel (US32D/630)
- Polished Stainless Steel (US32/629)
- Satin PVD Titanium
- Bright PVD Titanium

\*Other finishes available on request

### Escutcheon Options



Blind



Euro Cylinder



Privacy Thumb Turn and Release Set





# UNITY LEVER HANDLE

## SR04 Door Handle Series

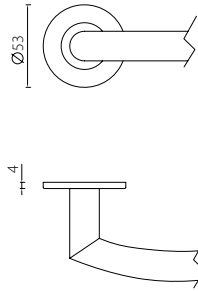

### Application

UNITY SR04 Series handle is built with minimalistic rose design for interior doors suitable for commercial and residential applications

### Specifications and Features

- EN1906 Grade 3 tested and EN1634-1 fire rated
- Made of stainless steel AISI304
- 4mm Un-Sprung rose design to present practical simplicity
- Concealed fixing
- Hexagonal countersunk to assist thru-bolt fixing
- Architectural look achieved by minimum rose height
- Fitted perfectly with UNITY ML1072/ML1085 series mortice lock for a firm lever action



### Tests and Standards



Successfully type-tested for conformity to all of the requirements of EN1906: 2010 (including 240-hours of corrosion resistance requirement of EN1670:2007)



Successfully passed 240-minutes fire test of metal door assemblies to EN1634-1:2014



All tests performed independently and certified by Exova/Warringtonfire/Warrington APT. Test reports and/or certificates are available on request

### Finishes

- Satin Stainless Steel (US32D/630)
- Polished Stainless Steel (US32/629)
- Satin PVD Titanium
- Bright PVD Titanium

\*Other finishes available on request

### Escutcheon Options



Blind

Euro Cylinder

Privacy Thumb Turn and Release Set

### EN1906: 2010 Classifications

3	7	-	1	1	4	0	B
---	---	---	---	---	---	---	---

# UNITY LEVER HANDLE

## SR05 Door Handle Series – Magnetic Round Rose

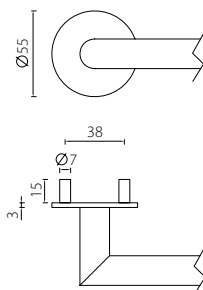

## SR15 Door Handle Series – Magnetic Square Rose

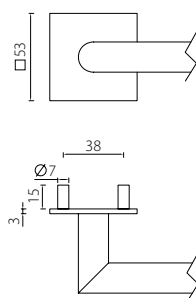

### Application

It is designed for modern door requiring a minimalistic door handle appearance

### Specifications and Features

- Made of stainless steel AISI304 (AISI316 is available on request)
- 3mm thickness spring assist rose cover design
- SS430 stainless steel cover with magnetic property
- Inner rose built with magnets to fit with the cover
- Available in both round and square rose design
- Standard Finish in Satin Stainless Steel (Other finish available on request)

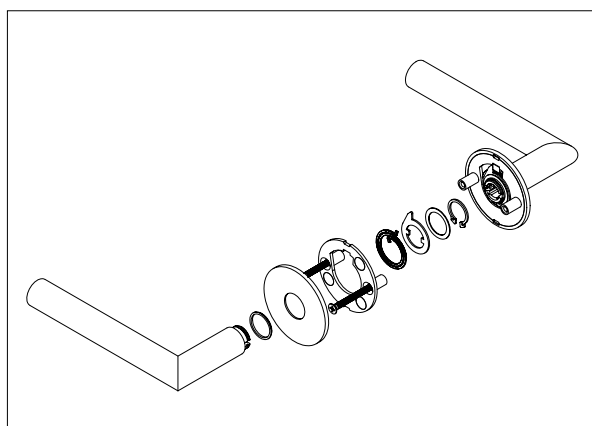

### Finishes

- Satin Stainless Steel (US32D/630)
- Polished Stainless Steel (US32/629)
- Satin PVD Titanium
- Bright PVD Titanium

\*Other finishes available on request

### Escutcheon Options

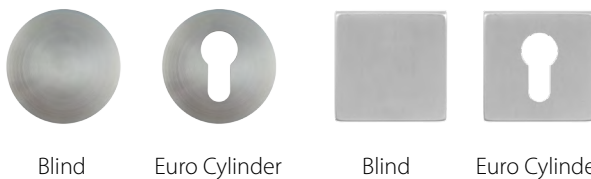

Blind

Euro Cylinder

Blind

Euro Cylinder

## UNITY LEVER HANDLE

### SR08 Door Handle Series – Tubular Latchset on Round Rose

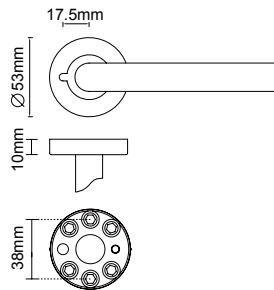

#### Application

For residential interior doors with passage, privacy, or dummy application

#### Specifications and Features

- Made of Stainless Steel AISI304 (AISI316 is available on request)
- D53mm round rose design
- Designed to use with UNITY RTL30 Series Tubular Latch
- Cover Rose can be used with privacy or passage function
- Based rose with multiple hole position for easy installation
- Special spring assisted spindle for easy and reliable function

#### Finishes

- Satin Stainless Steel (US32D/630)
- Polished Stainless Steel (US32/629)
- Satin PVD Titanium
- Bright PVD Titanium

\*Other finishes available on request

### SR18 Door Handle Series – Tubular Latchset on Square Rose

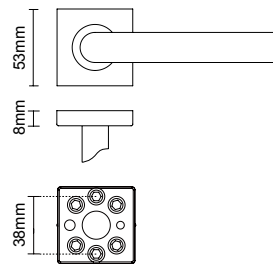

#### Application

For residential interior doors with passage, privacy, or dummy application

#### Specifications and Features

- Made of Stainless Steel AISI304 (AISI316 is available on request)
- 53 x 53mm square rose design with square inner rose
- Designed to use with UNITY RTL30 Series Tubular Latch
- Cover Rose can be used with privacy or passage function
- Based rose with multiple hole position for easy installation
- Special spring assisted spindle for easy and reliable function

#### Finishes

- Satin Stainless Steel (US32D/630)
- Polished Stainless Steel (US32/629)
- Satin PVD Titanium
- Bright PVD Titanium

\*Other finishes available on request

# UNITY LEVER HANDLE

## SR02 Door Handle Series – Handicap Handle

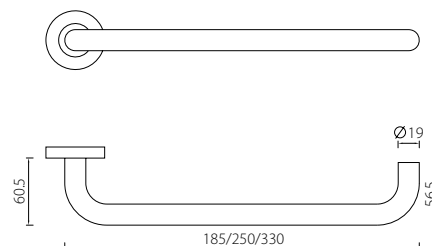

### Application

It is designed for hospital and healthcare facilities to assist ease of door opening

### Specifications and Features

- Made of stainless steel AISI304 (AISI316 is available on request)
- Rose design suitable for most of the European mortice lock
- U-shape return to door lever design applicable to commercial usage
- Concealed screw fixing
- Hexagonal countersunk and fixing lugs to assist thru-bolt fixing
- Robust spring mechanism to assist lever torque force
- Strong under-construction build to protect the mortice lock in application
- Available in 185 / 250 / 330mm length version
- Standard Finish in Satin Stainless Steel (Other finish available on request)

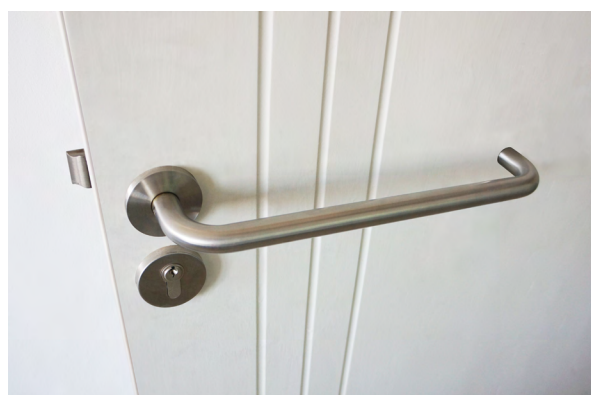

### Available Models

- SR02SL901: 185mm length version
- SR02SL902: 250mm length version
- SR02SL903: 330mm length version

### Tests and Standards



Successfully type-tested for conformity to all of the requirements of EN1906: 2010 (including 240-hours of corrosion resistance requirement of EN1670:2007)



Successfully passed 240-minutes fire test of metal door assemblies to EN1634-1:2014



All tests performed independently and certified by Exova/Warringtonfire/Warrington APT. Test reports and/or certificates are available on request

### EN1906: 2010 Classifications

3	7	-	1	1	4	0	B
---	---	---	---	---	---	---	---

### Finishes

- Satin Stainless Steel (US32D/630)
- Polished Stainless Steel (US32/629)
- Satin PVD Titanium
- Bright PVD Titanium

\*Other finishes available on request

# UNITY LEVER HANDLE

## SP07 Door Handle Series – Handicap Handle

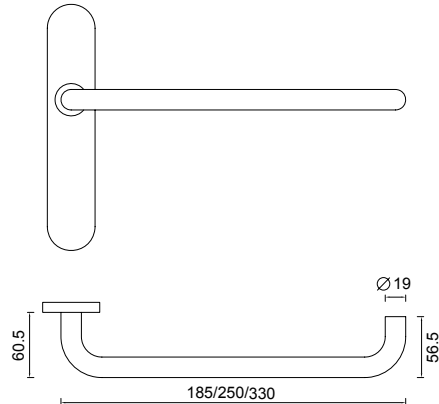

### Application

It is designed for hospital and healthcare facilities to assist ease of door opening

### Specifications and Features

- Made of stainless steel AISI304 (AISI316 is available on request)
- Plate design suitable for most of the European mortice lock
- U-shape return to door lever design applicable to commercial usage
- Concealed screw fixing
- Hexagonal countersunk and fixing lugs to assist thru-bolt fixing
- Robust spring mechanism to assist lever torque force
- Strong under-construction build to protect the mortice lock in application
- Available in 185 / 250 / 330mm length version
- Standard Finish in Satin Stainless Steel (Other finish available on request)



### Tests and Standards



Successfully type-tested for conformity to all of the requirements of EN1906: 2010 (including 240-hours of corrosion resistance requirement of EN1670:2007)



Successfully passed 240-minutes fire test of metal door assemblies to EN1634-1:2014



All tests performed independently and certified by Exova/Warringtonfire/Warrington APT. Test reports and/or certificates are available on request

### Available Models

- SR02SL901: 185mm length version
- SR02SL902: 250mm length version
- SR02SL903: 330mm length version

### EN1906: 2010 Classifications

3	7	-	1	1	4	0	B
---	---	---	---	---	---	---	---

### Finishes

- Satin Stainless Steel (US32D/630)
- Polished Stainless Steel (US32/629)
- Satin PVD Titanium
- Bright PVD Titanium

\*Other finishes available on request



# UNITY LEVER HANDLE

## SR03 Door Handle Series – Profile Door

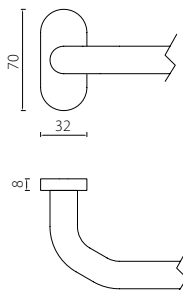

### Application

UNITY SR03 Series handle is an oval rose design suited for narrow stile door

### Specifications and Features

- Double action spring loaded rose design (Upward or downward operation)
- Concealed fixing
- Hexagonal countersunk to assist thru bolt fixing
- Successfully type-tested for conformity to all of the requirements of EN1906: 2010 (including 240-hours of corrosion resistance requirement of EN1670:2007)
- Standard Finish: Satin Stainless Steel (Other finish available on request)



### Tests and Standards



Successfully type-tested for conformity to all of the requirements of EN1906: 2010 (including 240-hours of corrosion resistance requirement of EN1670:2007)



Successfully passed 240-minutes fire test of metal door assemblies to EN1634-1:2014



All tests performed independently and certified by Exova/Warringtonfire/Warrington APT. Test reports and/or certificates are available on request

### Escutcheon Options



Blind



Euro Cylinder

### Finishes

- Satin Stainless Steel (US32D/630)
- Polished Stainless Steel (US32/629)
- Satin PVD Titanium
- Bright PVD Titanium

\*Other finishes available on request

# UNITY LEVER HANDLE

## Window Handle Series



### SR30 Window Handle Series

#### Application

It is designed for modern door requiring a minimalistic door handle appearance

#### Specifications and Features

- Zinc Cast base for durable performance
- Ball bearing loaded 4-point stop design for wide window application
- Concealed fixing
- Spindle drive mechanism

### SR31 Window Handle Series

#### Application

It is designed for modern door requiring a minimalistic door handle appearance

#### Specifications and Features

- Plastic base rose design
- 4-point stop design for wide window application
- Concealed fixing
- Spindle drive mechanism

#### Finishes

- Satin Stainless Steel (US32D/630)
- Polished Stainless Steel (US32/629)
- Satin PVD Titanium
- Bright PVD Titanium

\*Other finishes available on request



# UNITY LEVER HANDLE

## SP07 Door Handle Series

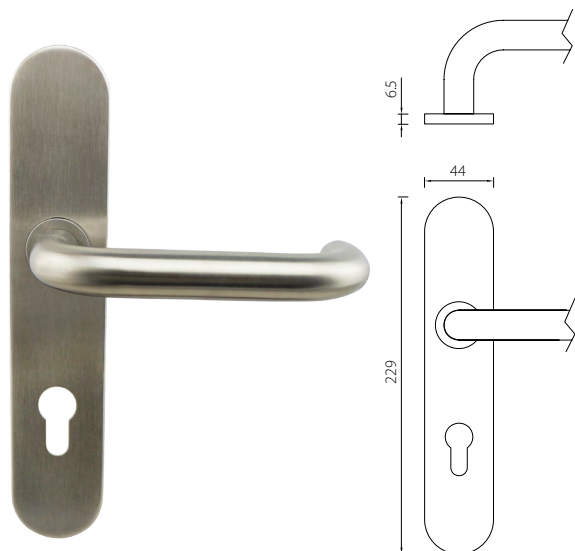

### Application

UNITY SP07 Series handle is built with long size plate design for commercial and residential application

### Specifications and Features

- EN1906 Grade 3 tested and EN1634-1 fire rated
- Made of stainless steel AISI304
- Concealed fixing
- Loaded with spring mechanism
- Compatible with both 72mm and 85mm center mortice locks and perfectly fitted with UNITY ML10/ML20 series mortice lock
- Hexagonal countersunk to assist thru-bolt fixing
- Good for retrofitting (to cover unwanted screw positions)

### Tests and Standards



Successfully type-tested for conformity to all of the requirements of EN1906: 2010 (including 240-hours of corrosion resistance requirement of EN1670:2007)



Successfully passed 240-minutes fire test of metal door assemblies to EN1634-1:2014



All tests performed independently and certified by Exova/Warringtonfire/Warrington APT. Test reports and/or certificates are available on request

### EN1906: 2010 Classifications

3	7	-	1	1	4	0	B
---	---	---	---	---	---	---	---

### Finishes

- Satin Stainless Steel (US32D/630)
- Polished Stainless Steel (US32/629)
- Satin PVD Titanium
- Bright PVD Titanium

\*Other finishes available on request

### Escutcheon Options

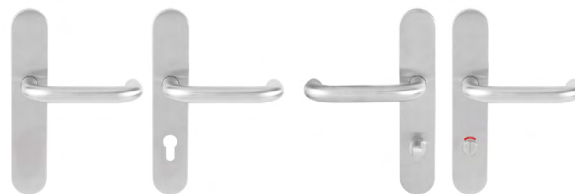

Blind

Euro Cylinder

Privacy Thumb Turn and Release Set

# UNITY LEVER HANDLE

## SP09 Door Handle Series

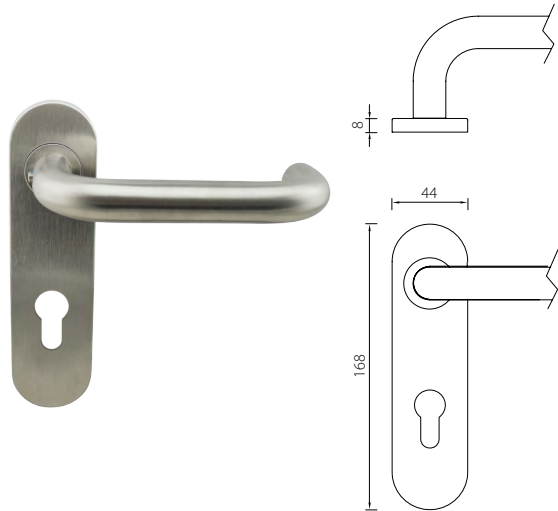

### Application

UNITY SP09 Series handle is built with medium size plate design for commercial and residential application

### Specifications and Features

- EN1906 Grade 3 tested and EN1634-1 fire rated
- Made of stainless steel AISI304
- Concealed fixing
- Loaded with spring mechanism
- Compatible with both 72mm center mortice locks and perfectly fitted with UNITY ML10/ML20 series mortice lock
- Hexagonal countersunk to assist thru-bolt fixing
- Good for retrofitting with current fire rated door handle

### Tests and Standards



Successfully type-tested for conformity to all of the requirements of EN1906: 2010 (including 240-hours of corrosion resistance requirement of EN1670:2007)



Successfully passed 240-minutes fire test of metal door assemblies to EN1634-1:2014



All tests performed independently and certified by Exova/Warringtonfire/Warrington APT. Test reports and/or certificates are available on request

### EN1906: 2010 Classifications

3	7	-	1	1	4	0	B
---	---	---	---	---	---	---	---

### Finishes

- Satin Stainless Steel (US32D/630)
- Polished Stainless Steel (US32/629)
- Satin PVD Titanium
- Bright PVD Titanium

\*Other finishes available on request

### Escutcheon Options



Blind

Euro Cylinder

Privacy Thumb Turn and Release Set

# UNITY LEVER HANDLE

## SP14 Door handle Series

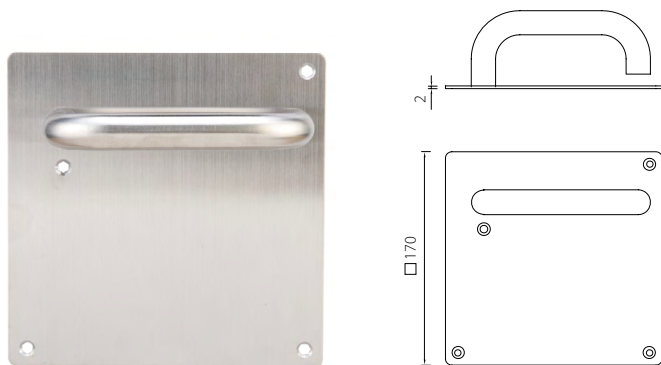

### Application

UNITY SP14 Series handle is designed for commercial application such as hospitals where frequent usage presents

### Specifications and Features

- EN1906 Grade 3 tested and EN1634-1 fire rated
- Made of stainless steel AISI304
- Reliable 4 position fixing with under lever fixing position designed to go through most popular DIN/EN standard mortice lock case
- Un-Sprung design

### Tests and Standards



Successfully type-tested for conformity to all of the requirements of EN1906: 2010 (including 240-hours of corrosion resistance requirement of EN1670:2007)



Successfully passed 240-minutes fire test of metal door assemblies to EN1634-1:2014



All tests performed independently and certified by Exova/Warringtonfire/Warrington APT. Test reports and/or certificates are available on request

### EN1906: 2010 Classifications

3	7	-	1	1	4	0	B
---	---	---	---	---	---	---	---

### Finishes

- Satin Stainless Steel (US32D/630)
- Polished Stainless Steel (US32/629)
- Satin PVD Titanium
- Bright PVD Titanium

\*Other finishes available on request

### Escutcheon Options



Blind



Euro Cylinder



Privacy Thumb Turn and Release Set





# UNITY LEVER HANDLE

## SP13 Door handle Series

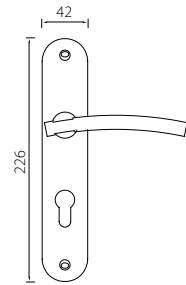
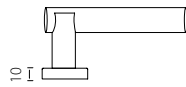

Cylinder (CYL)

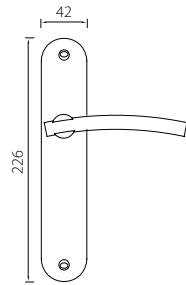

Blind (BDC)

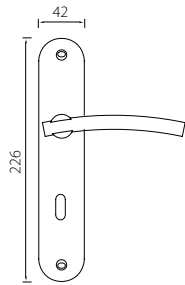

Key (BS)

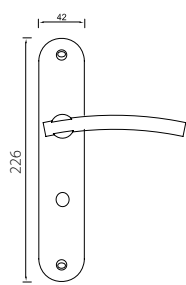

WC (CDT)

## SP16 Long Plate handle Series

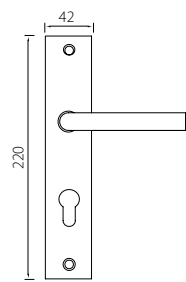
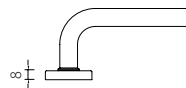

Cylinder (CYL)

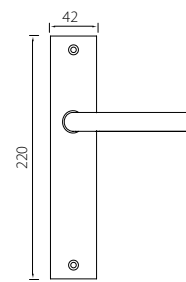

Blind (BDC)

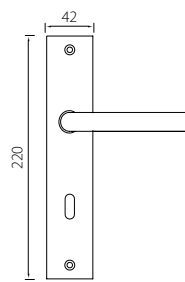

Key (BS)

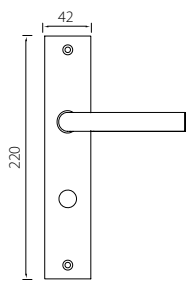

WC (CDT)

### Specifications and Features

- Face fixing non handed installation
- Spring loaded plated design
- Suited for 70 – 85mm mortice lock centers and retrofit with most of the French plate handle of 195mm fixing centers
- Standard finish in Satin Stainless Steel



# UNITY LEVER HANDLE

## SP15 Door handle Series

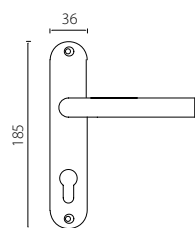
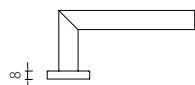

Cylinder (CYL)

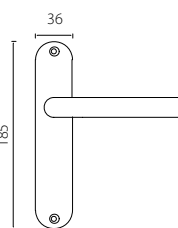

Blind (BDC)

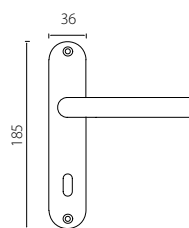

Key (BS)

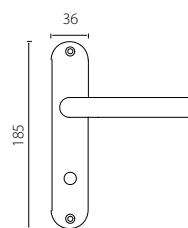

WC (CDT)

### Specifications and Features

- Face fixing non handed installation
- Spring loaded or Unsprung plated design
- Suited for 70 mortice lock centers and retrofit with most of the French plate handle of 165mm fixing centers
- Standard finish in Satin Stainless Steel



# UNITY LEVER HANDLE

## SP12 Door Handle Series

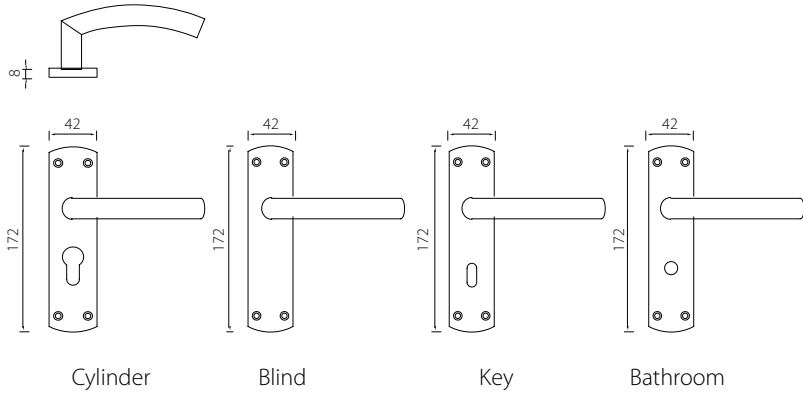

### Specifications and Features

- Face fixing non handed installation
- Spring loaded plated design
- Suited for UK size lever lock centers

### Finishes

- Satin Stainless Steel (US32D/630)
- Polished Stainless Steel (US32/629)
- Satin PVD Titanium
- Bright PVD Titanium

\*Other finishes available on request



# UNITY LEVER HANDLE

## SP03 Door Handle Series – Profile Door

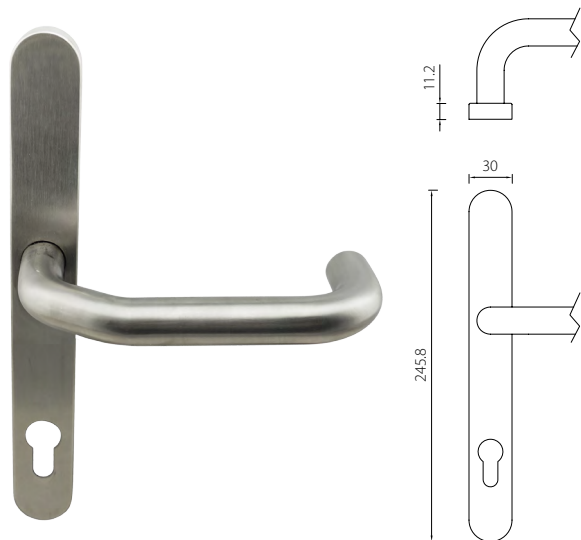

### Application

UNITY SP03 handle series is a narrow plate design for profile door

### Specifications and Features

- Spring loaded plate design
- Concealed fixing
- Hexagonal countersunk to assist thru bolt fixing
- Suitable for most of the European mortice lock
- Multiple thru fixing bolt hole position
- Successfully type-tested for conformity to all of the requirements of EN1906: 2010 (including 240-hours of corrosion resistance requirement of EN1670:2007)

### EN1906: 2010 Classifications

3	7	-	1	1	4	0	B
---	---	---	---	---	---	---	---

### Finishes

- Satin Stainless Steel (US32D/630)
- Polished Stainless Steel (US32/629)
- Satin PVD Titanium
- Bright PVD Titanium

\*Other finishes available on request

### Tests and Standards



Successfully type-tested for conformity to all of the requirements of EN1906: 2010 (including 240-hours of corrosion resistance requirement of EN1670:2007)



Successfully passed 240-minutes fire test of metal door assemblies to EN1634-1:2014



All tests performed independently and certified by Exova/Warringtonfire/Warrington APT. Test reports and/or certificates are available on request

# UNITY LEVER HANDLE

## SP04 Door Handle Series – Profile Door

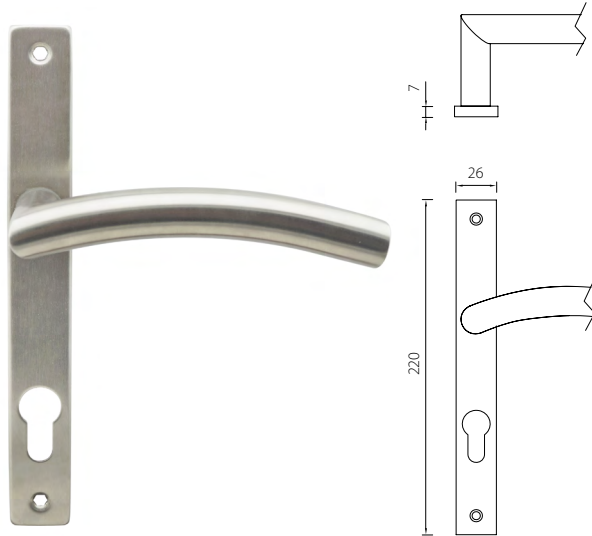

### Application

UNITY SP04 Series handle is a very narrow plate design for slim profile door

### Specifications and Features

- Face fix design
- Spring loaded plate design
- for most of the European mortice lock (70/72/85/90/92mm centers)
- Successfully type-tested for conformity to all of the requirements of EN1906: 2010 (including 240-hours of corrosion resistance requirement of EN1670:2007)



### Finishes

- Satin Stainless Steel (US32D/630)
- Polished Stainless Steel (US32/629)
- Satin PVD Titanium
- Bright PVD Titanium

\*Other finishes available on request



# UNITY

14th Floor North Block, 77 Mu Xu Yuan Street, Nanjing 210007, P.R. CHINA

TEL: +86.25.86932520 FAX: +86.25.86932510

Website: <http://www.unityhardware.com>, <http://unityhardware.en.alibaba.com>

Email: [sales@unityhardware.com](mailto:sales@unityhardware.com)